



HIGH QUALITY SCALE MODEL, RESIN MODEL
Polikarpov I-153 Chaika

The Polikarpov I-153 was the last of Nikolai Polikarpov's biplane fighter aircraft to enter service, and despite being the most advanced entry in the series was already obsolete when it first entered service in 1939.

Work on the I-153 was officially approved on 11 October 1937. Polikarpov's main aim was to reduce drag and weight in an attempt to compensate for the weight of a heavier engine. He did this in two main ways - first by introducing a retractable undercarriage, and second by returning to the 'gull wing' configuration of the I-15.

The first prototype's maiden flight is variously reported as having taken place in May or August 1938, with A.I. Zhukov at the controls.

The I-153 had a successful combat debut. The I-153 first saw combat in 1939 during the Soviet-Japanese Battle of Khalkin Gol in Mongolia. Ninety three I-153s were provided to China (a tiny proportion of the overall Soviet contribution to the war effort against Japan in 1937-1941). The I-153 saw combat during the Winter War against Finland (1939-1940), probably suffering heavy losses against the small Finnish Air Force.

The I-153 remained in use as a front line fighter until early in 1942, but by then very few aircraft were still intact, having been lost in the air, on the ground and while acting as ground attack aircraft. The surviving aircraft remained in use in secondary roles into 1943, although they were also used as ground attack aircraft. By the middle of 1943 the Red Air Force only had 36 I-153s on its strength. A few remained in service in the Far East as late as 1945.

Operators:

China - Chinese Nationalist Air Force

Finland - Finnish Air Force operated 21 captured aircraft

Germany - Luftwaffe operated captured aircraft.

Soviet Union - Soviet Air Force & Soviet Naval Aviation

TECHNICAL DATA

Crew: 1
 Length: 20.2ft
 Wing span: 32.8ft
 Height: 9ft 8in
 Empty Weight: 3,031lb
 Loaded Weight: 3,891lb
 Engine: Shvetsov M-62
 Power: 800hp
 Max Speed: 264mph at 16,400ft
 Service Ceiling: 36,100ft
 Range: 348 miles
 Armament: Four ShKAS 7.62mm
 machine guns
 Bomb-load: 441lb on four under wing
 bomb rack or eight air-to-ground
 rockets

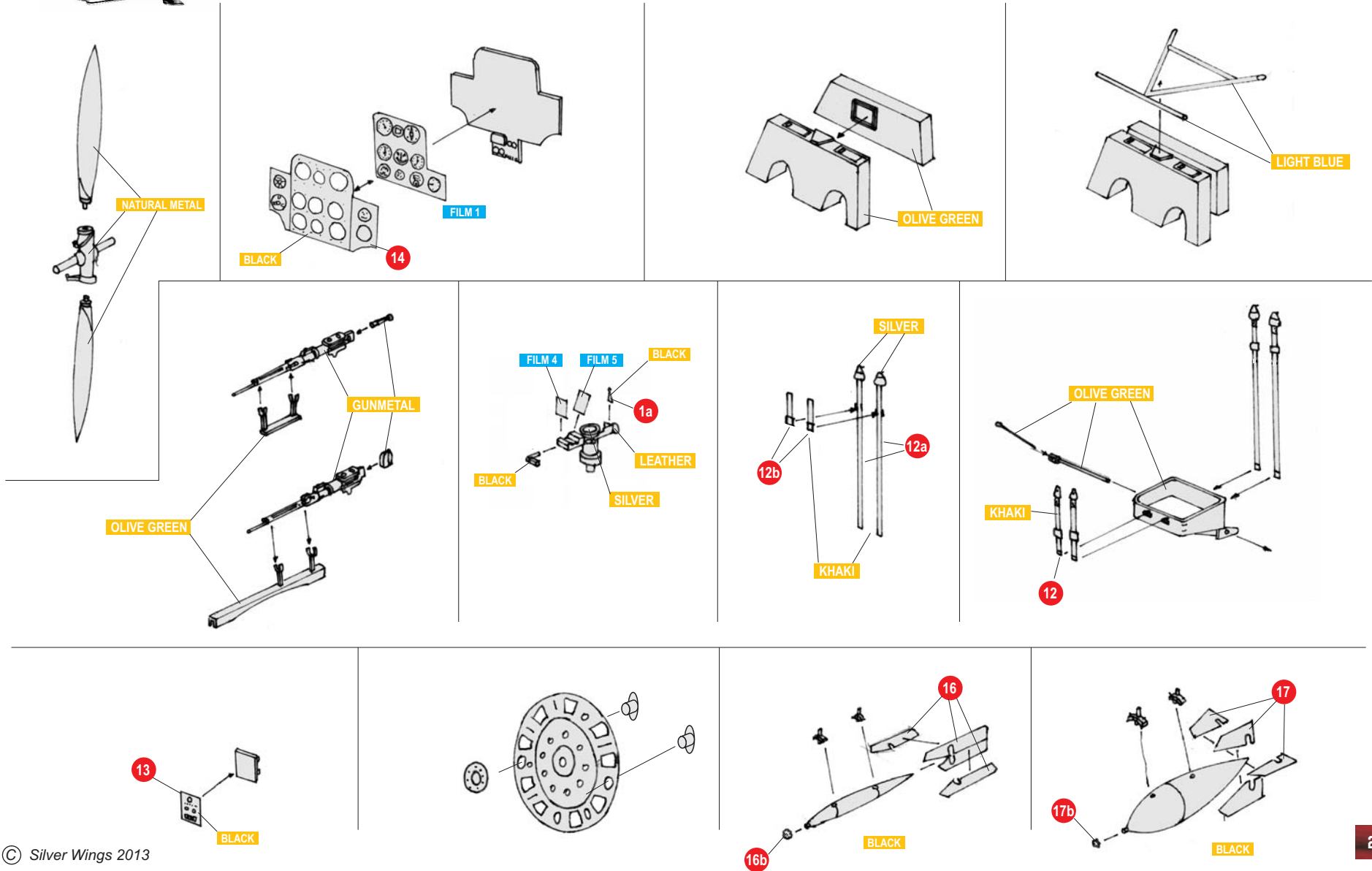

11

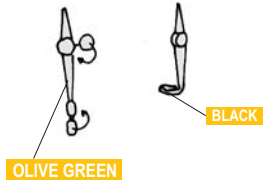

8

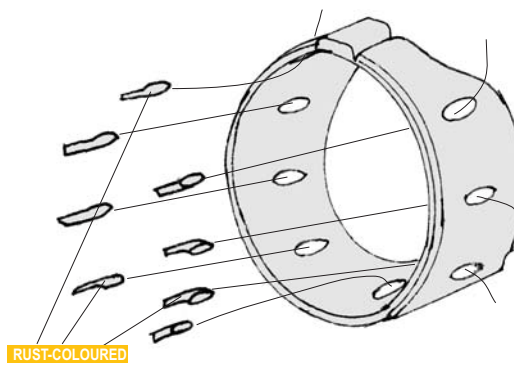
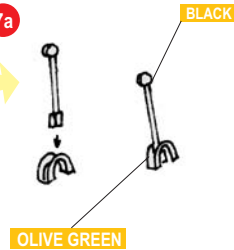
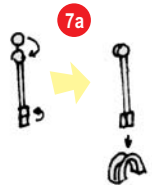
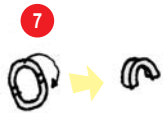
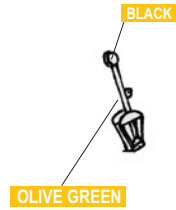
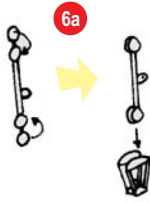
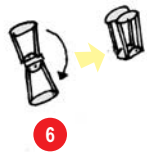
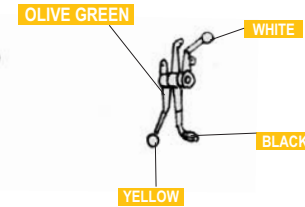
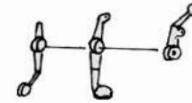
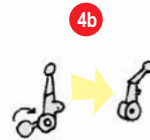
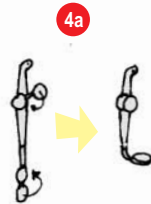
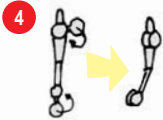
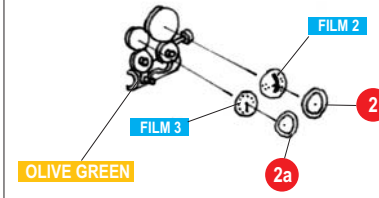
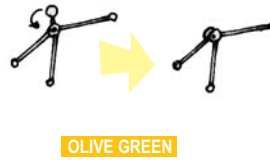

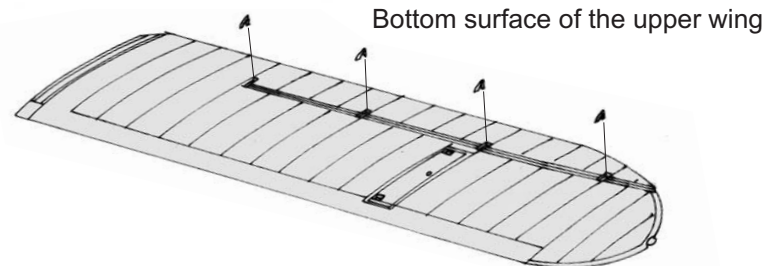
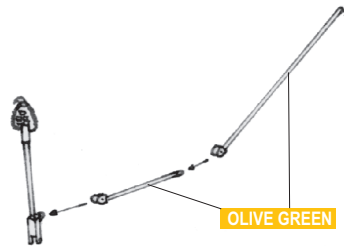
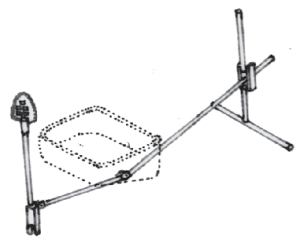
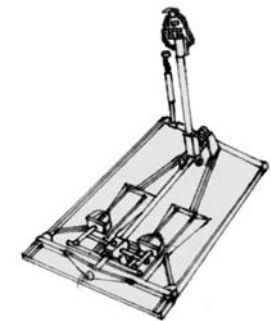
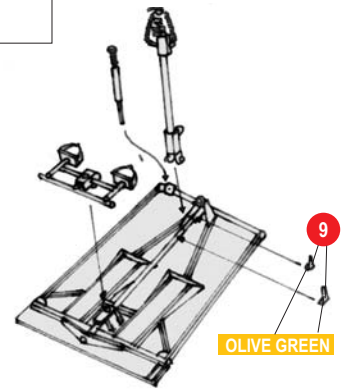
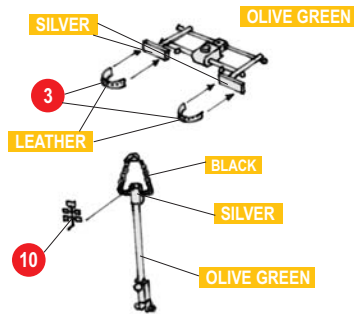
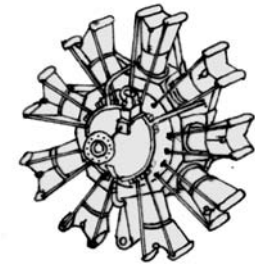
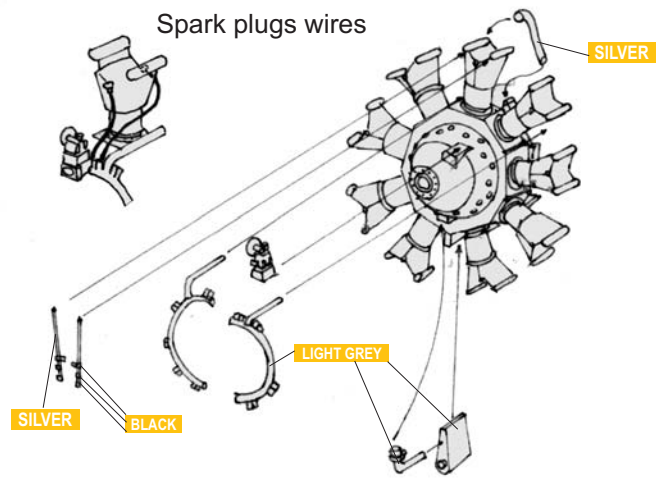
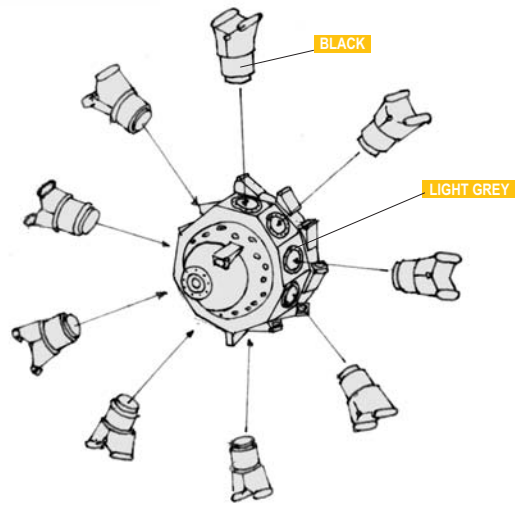

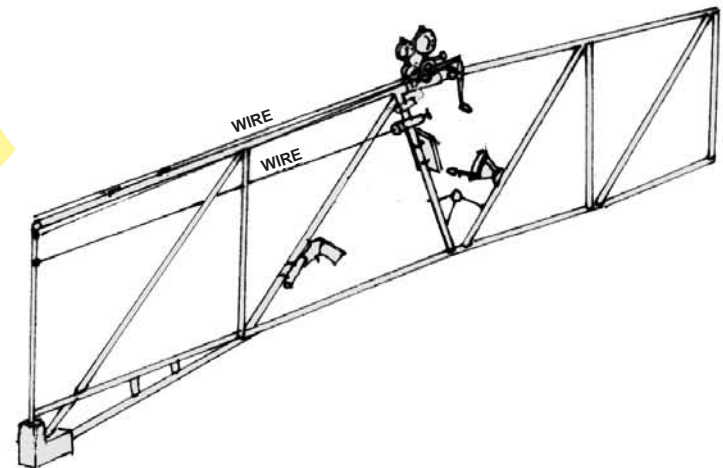
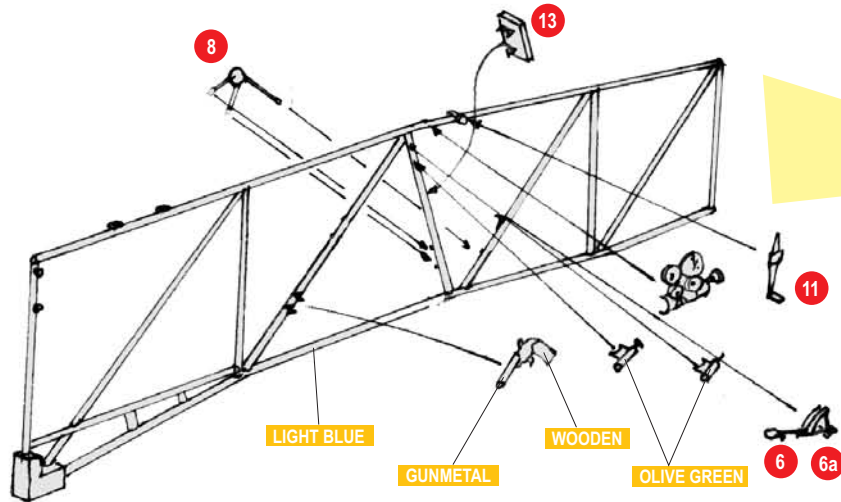
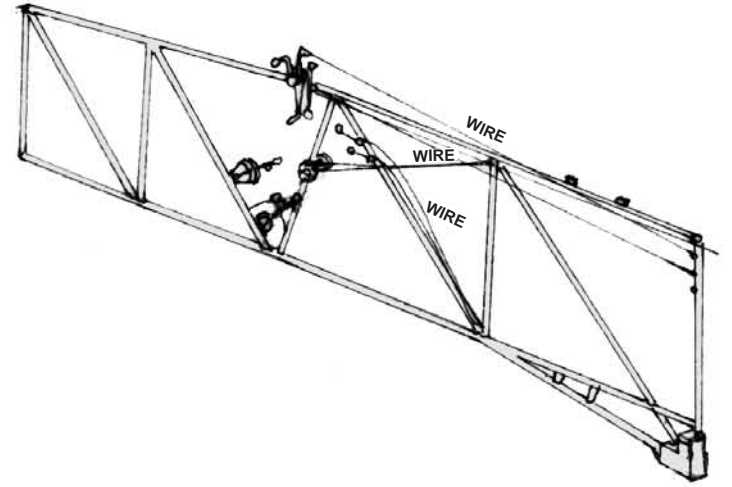
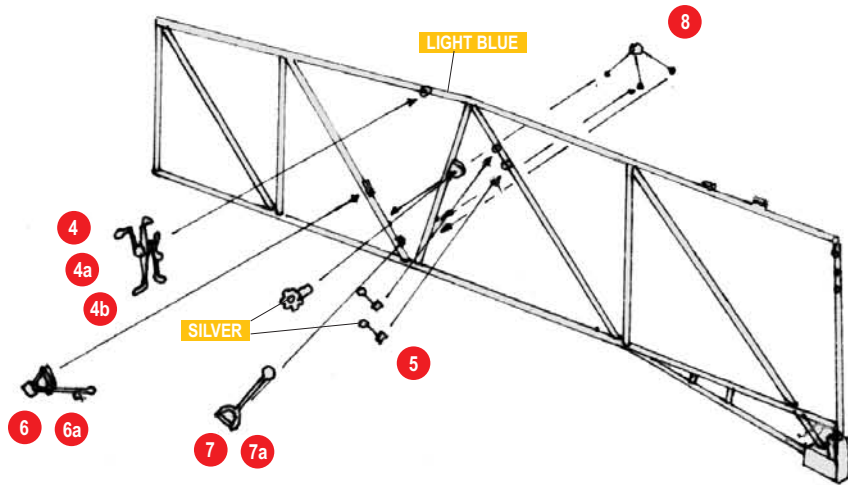

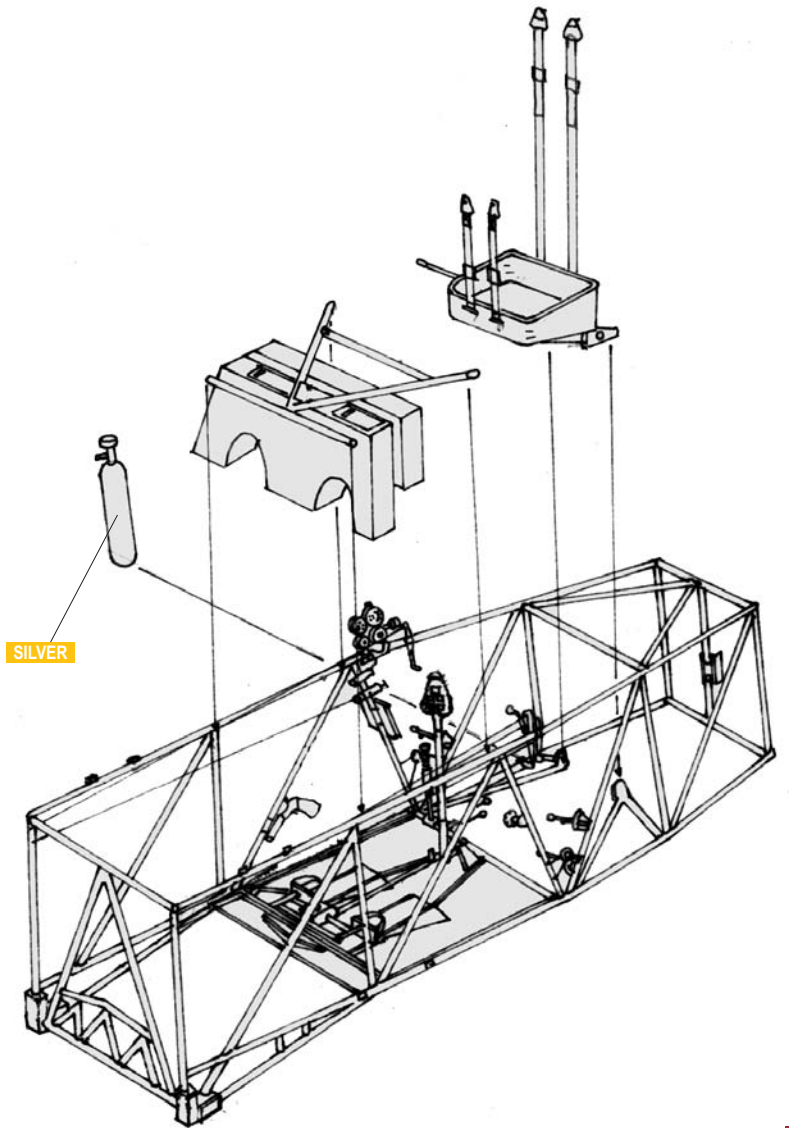
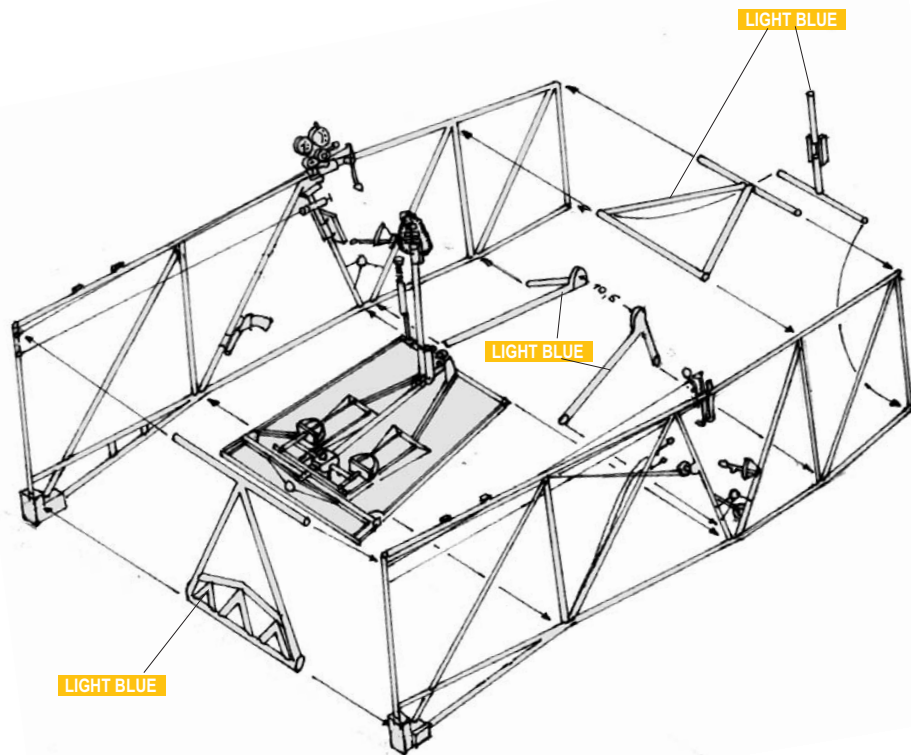

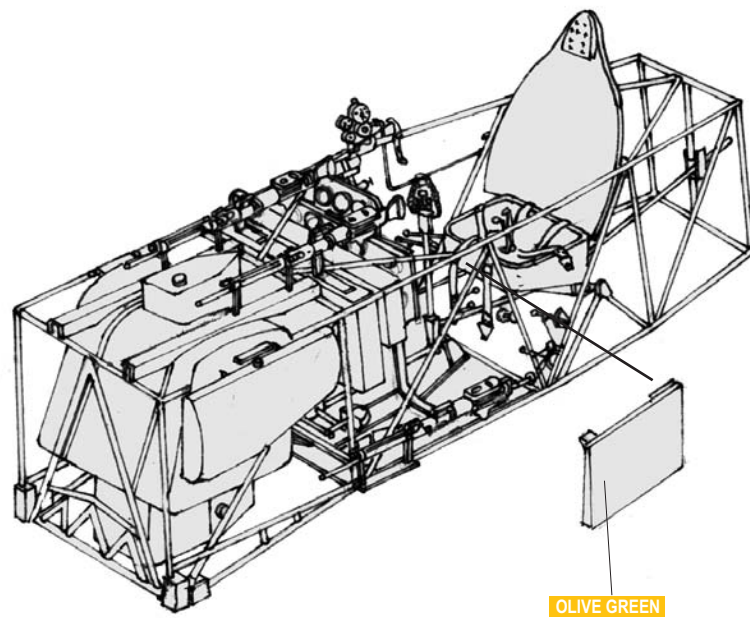
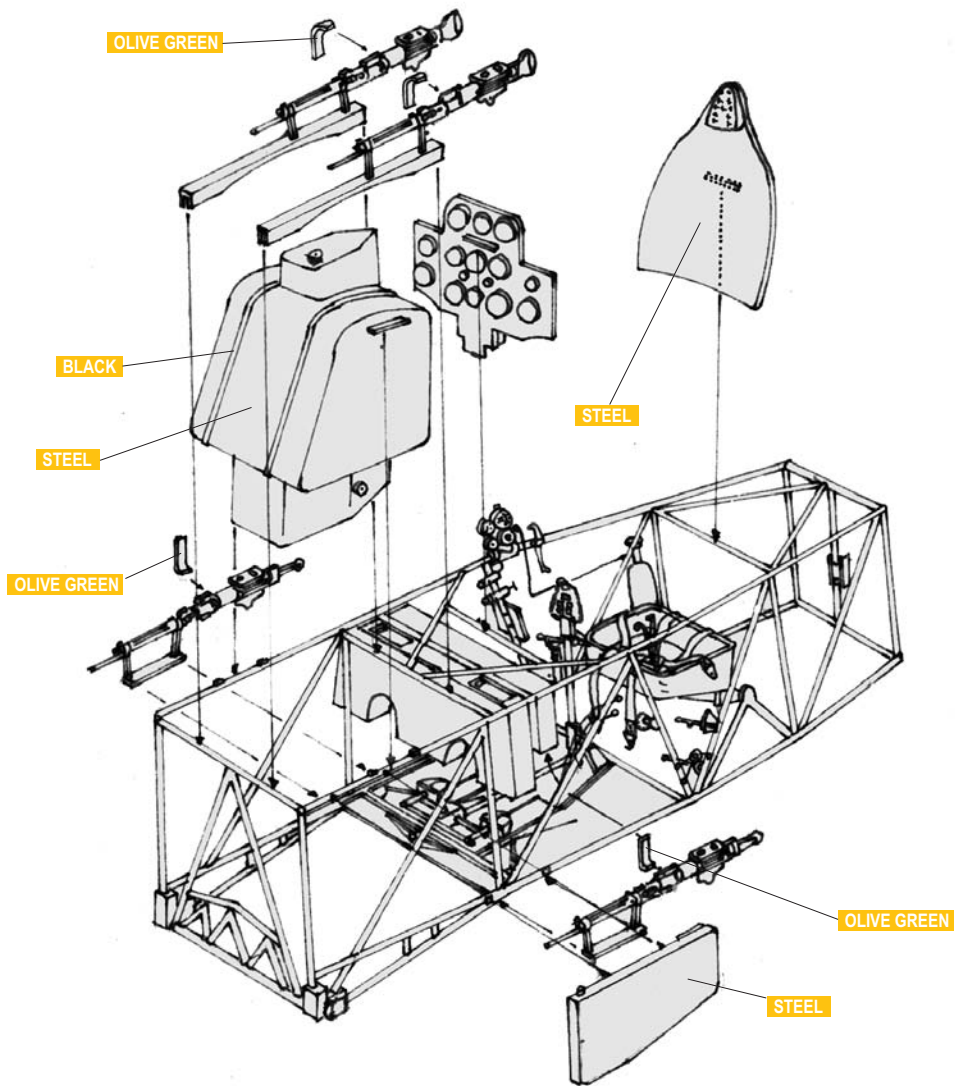

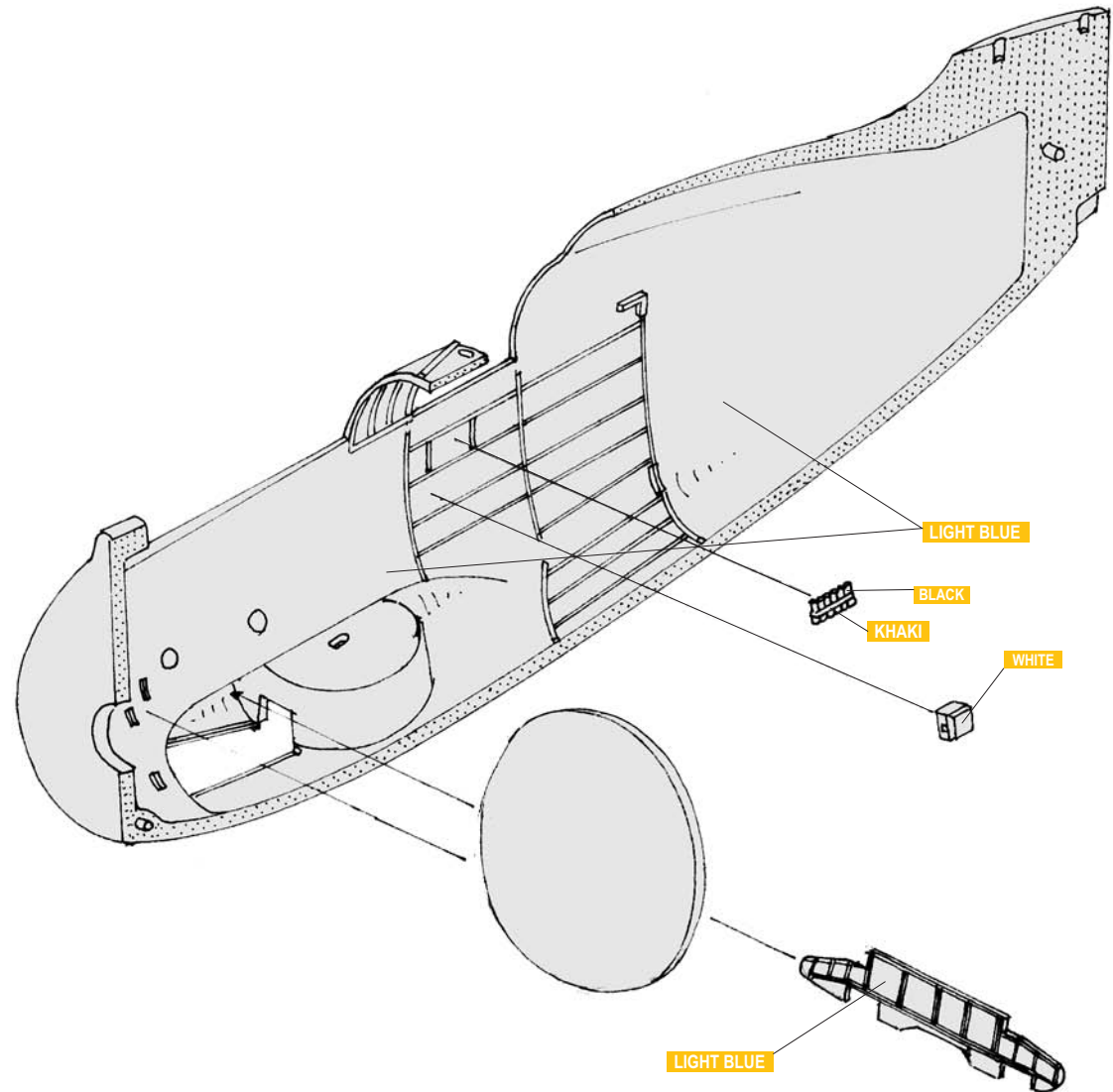
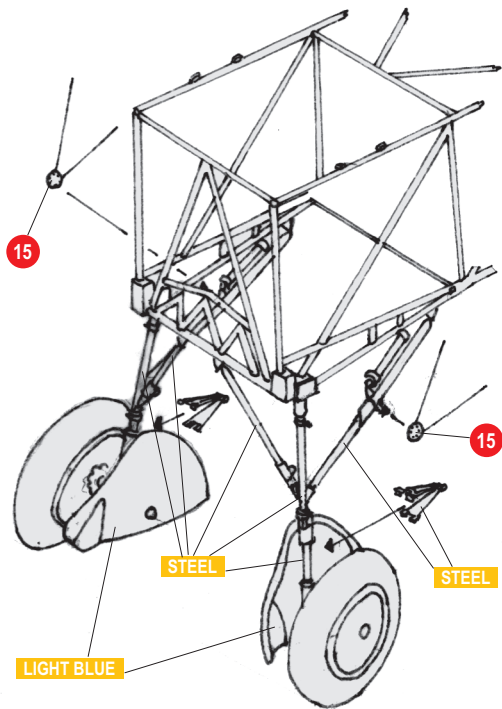

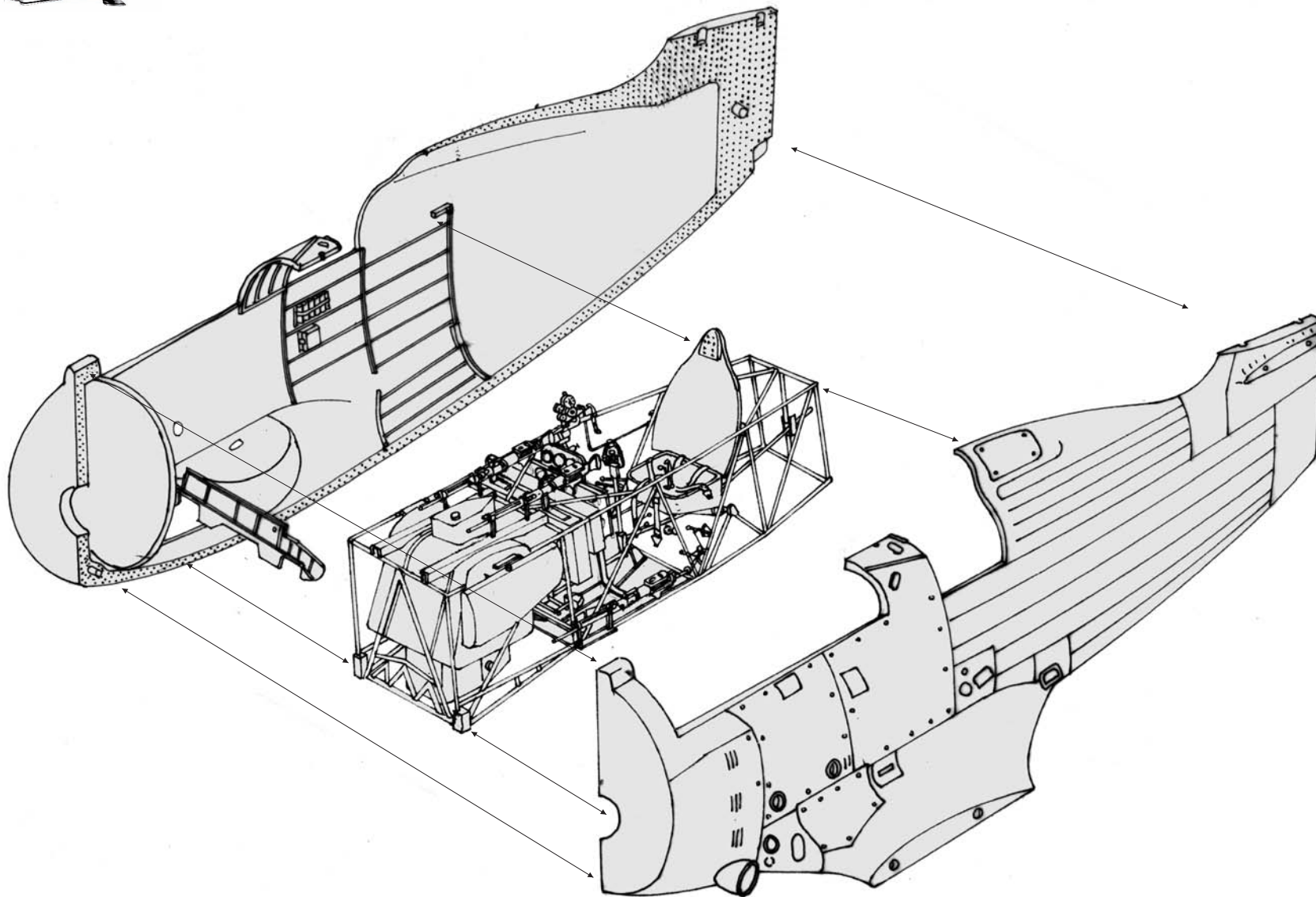

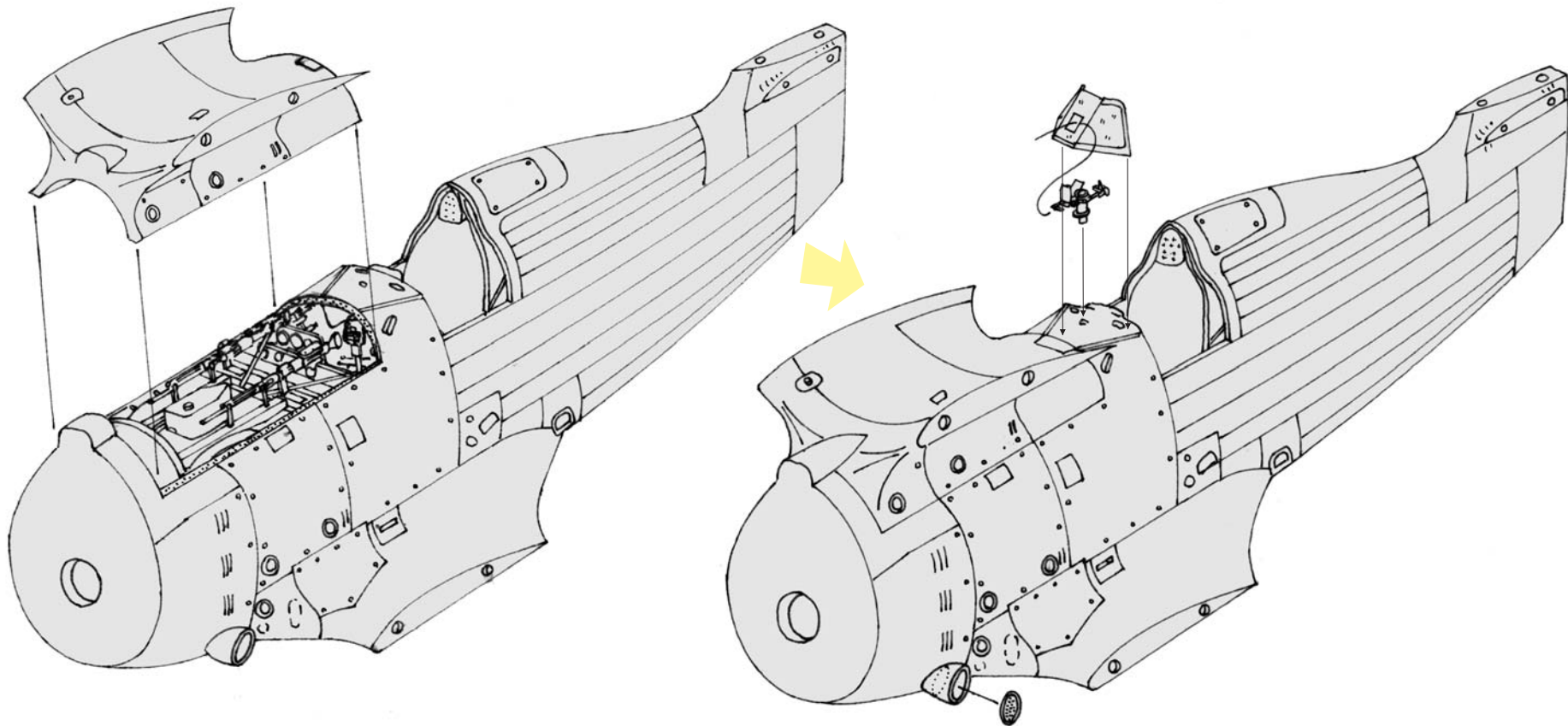

Wiring

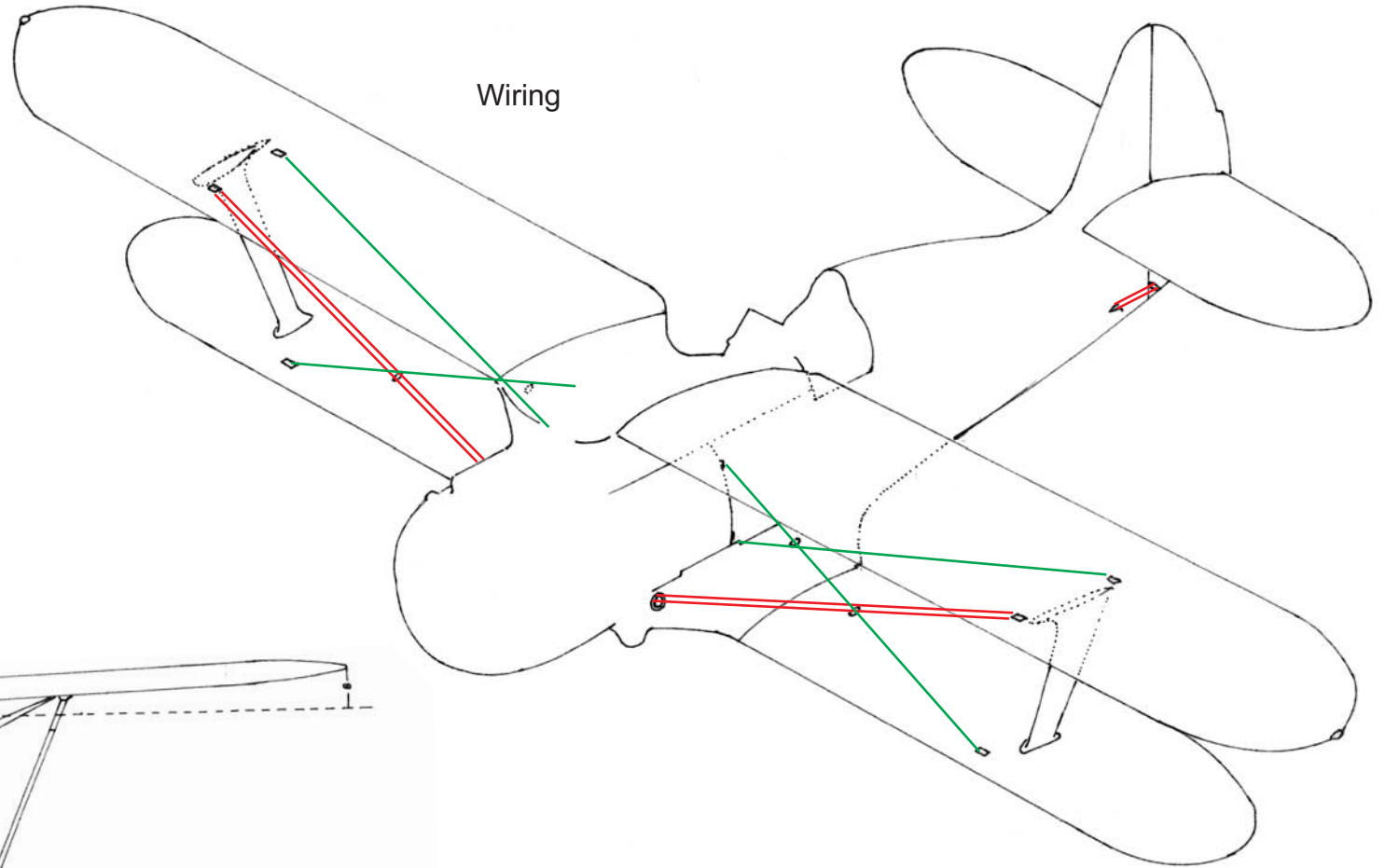

Wings angle

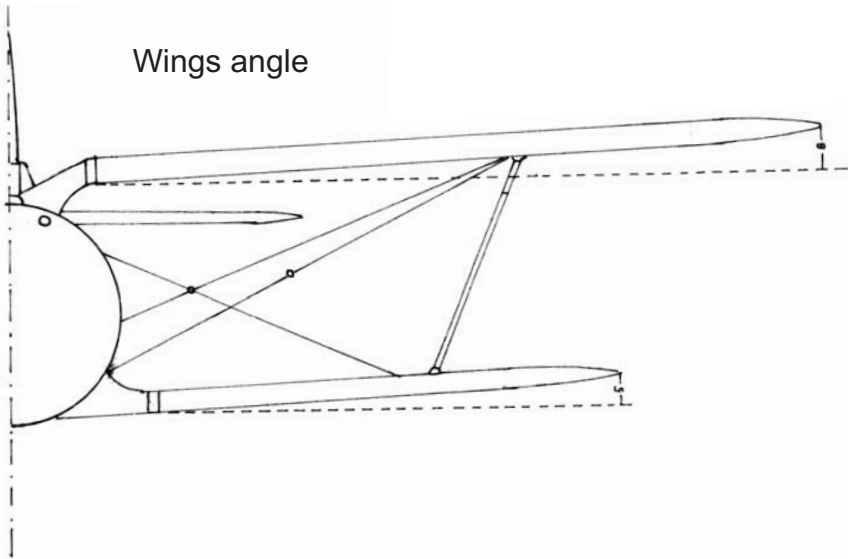

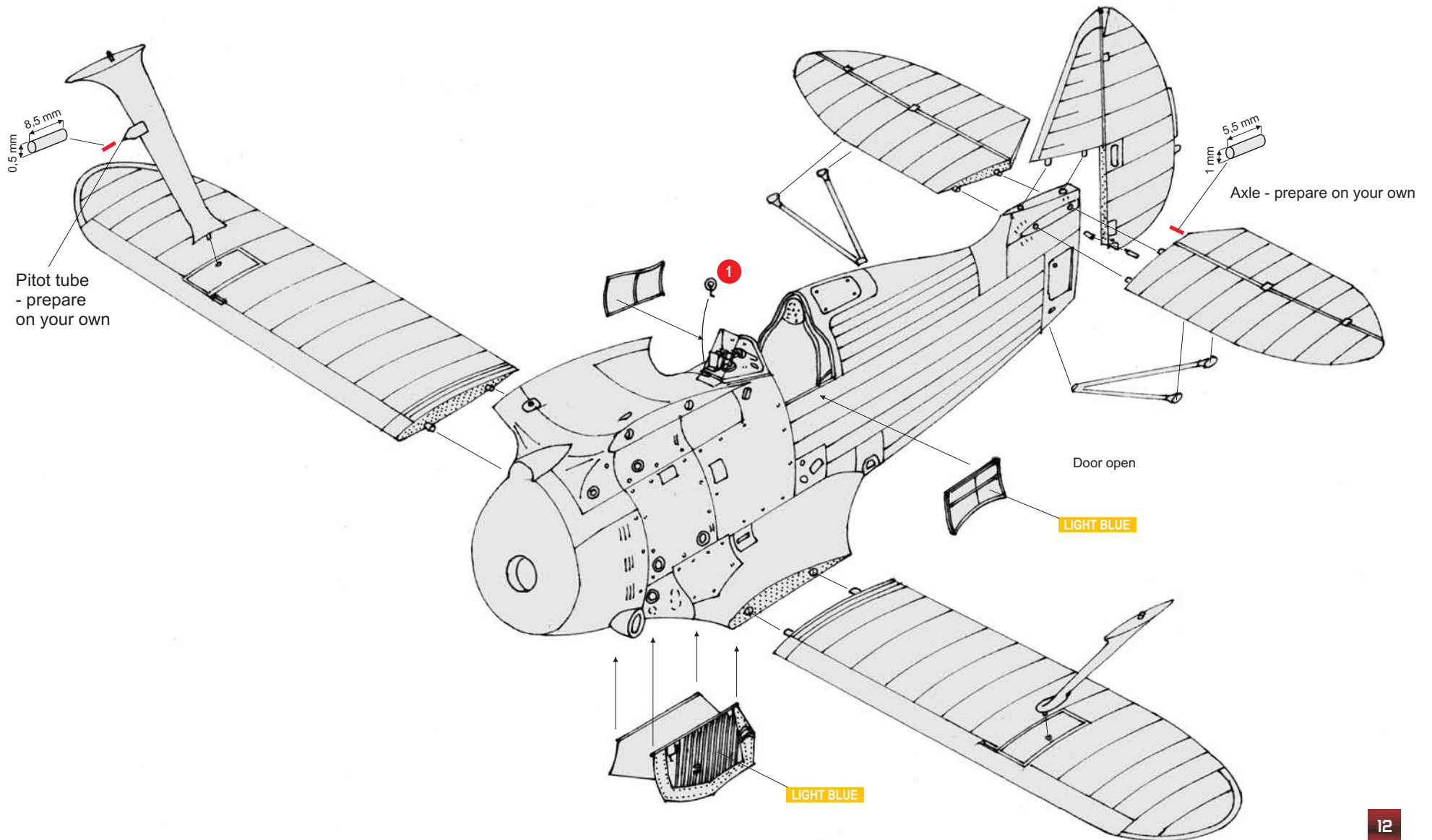

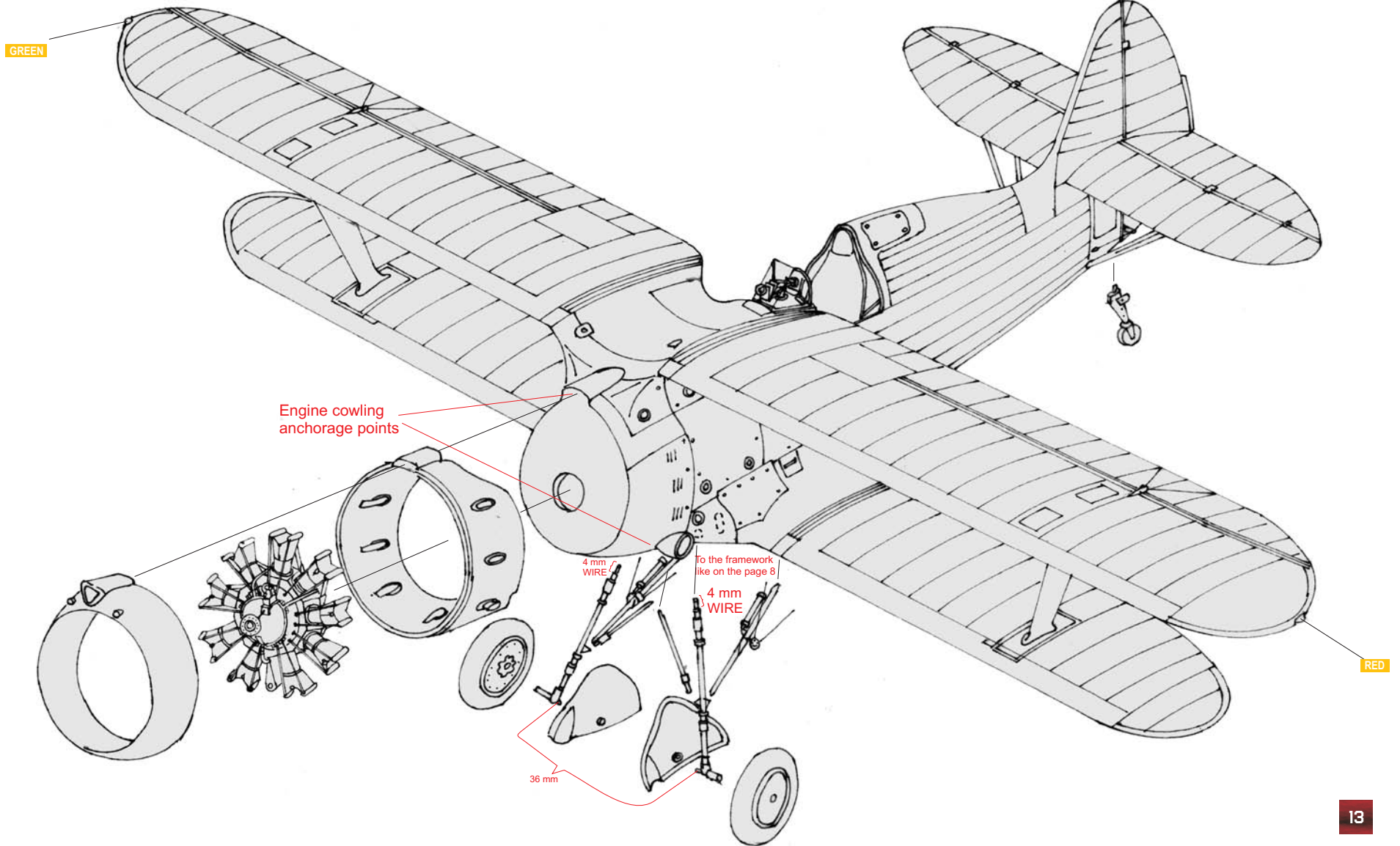

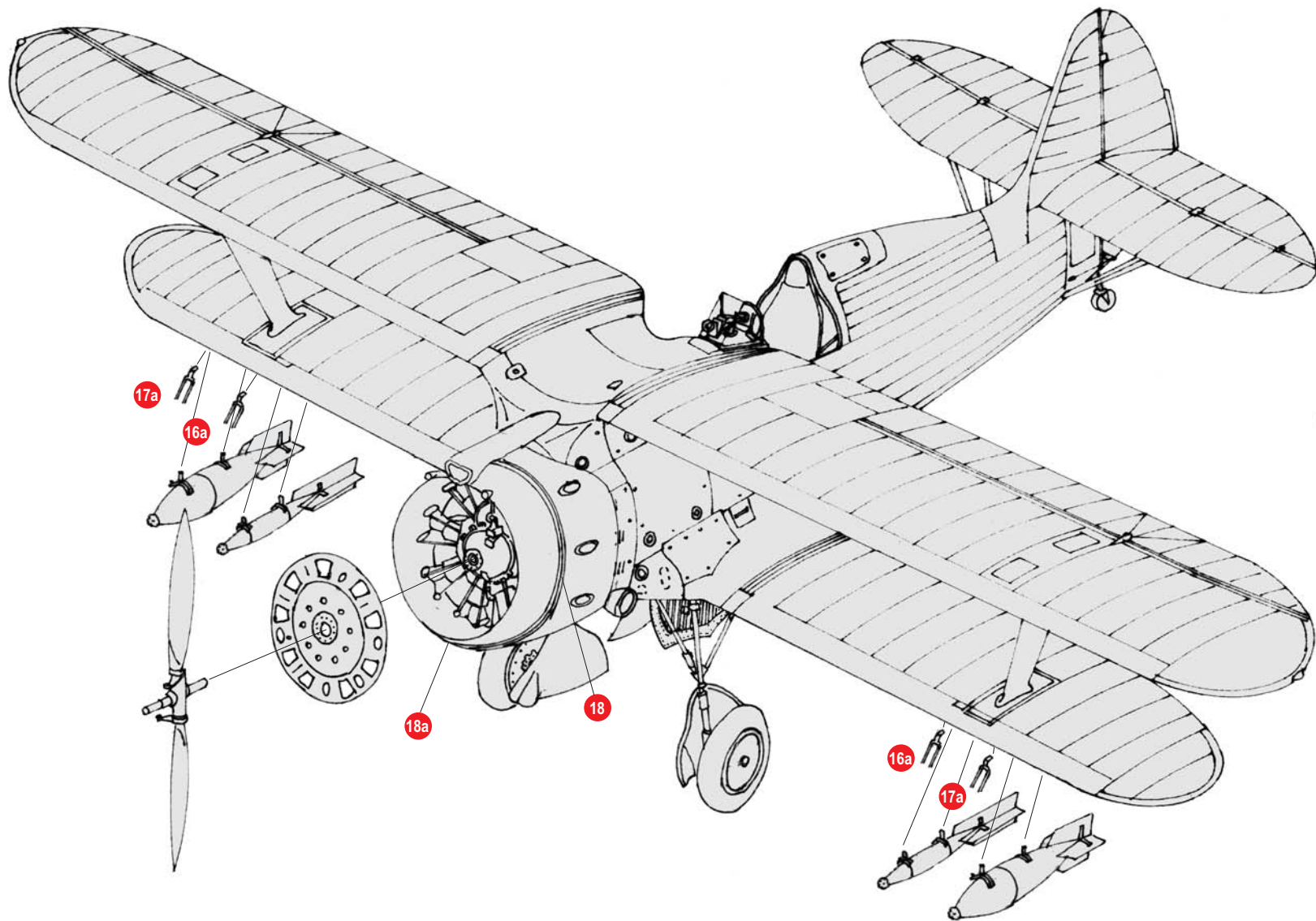

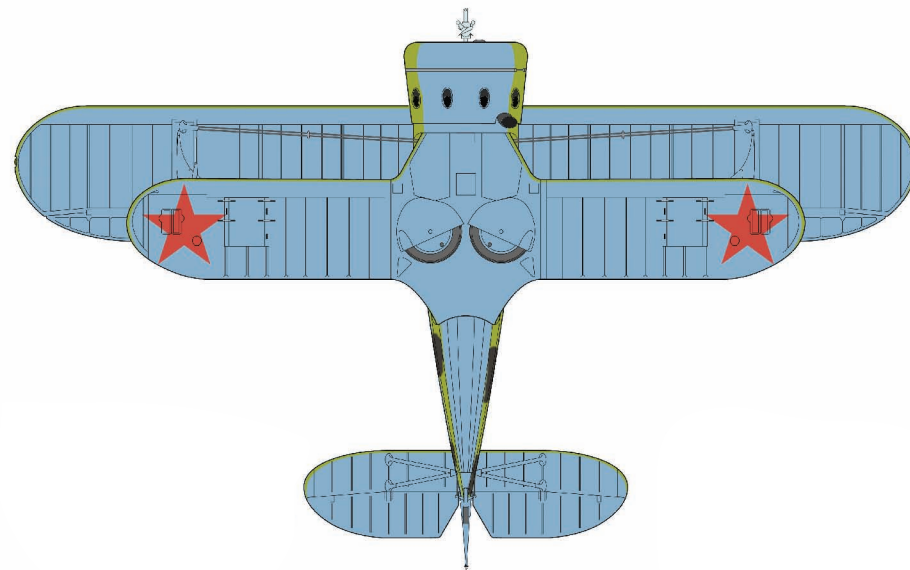
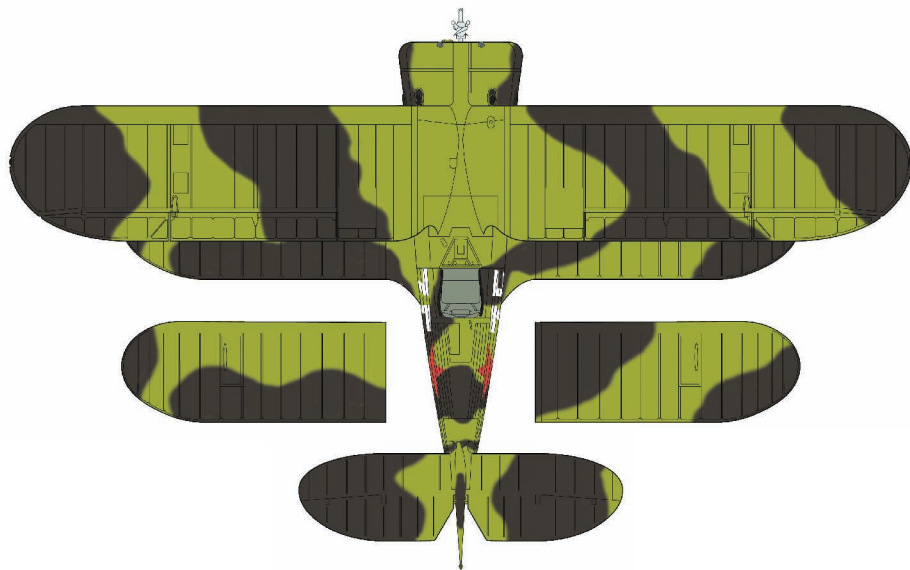





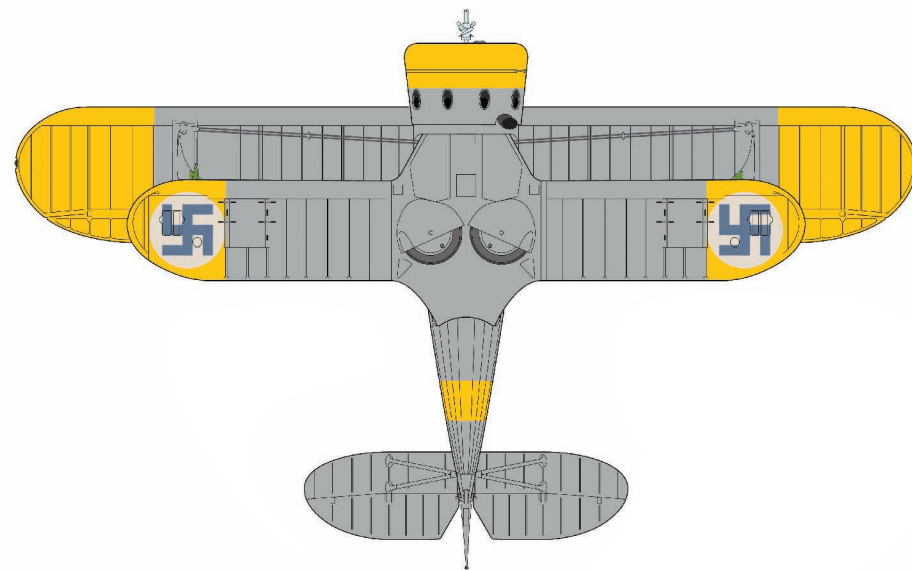
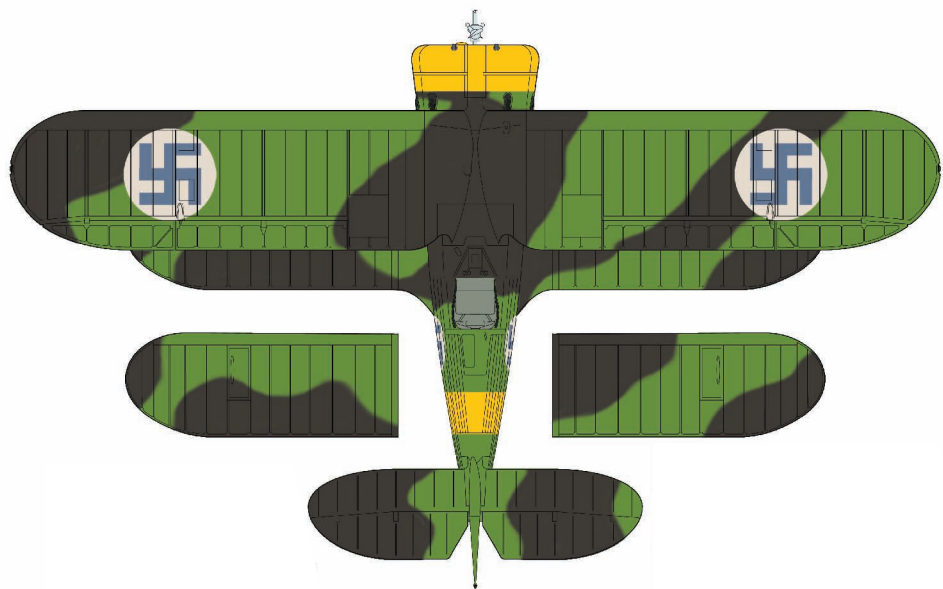

-  Interior Gray F.S. 24226
-  Insignia Red F.S. 31302
-  All Blue F.S. (1,2,3) 5466
-  All Green new F.S. (1,2,3) 4258
-  All Black F.S. (1,2,3) 7038



-  Valkoinen (White) F.S. 37722
-  Keltalnem (Identification color) F.S. 13655
-  Sininen (Insignia blue) F.S. 35102, F.S. 25123
-  Vaalean Sininen (Light blue) F.S. 35414
-  All Green old F.S. (3)4151
-  Musta (Black) F.S. 37038

The resin cast made by
HK Resin Model Henryk Kurowski
www.resinmodel.pl

© Silver Wings 2013